



Start Small

Add More Variety

Expand & Enjoy!

PLANTING DIAGRAM

FULL SUN / DRY SOIL

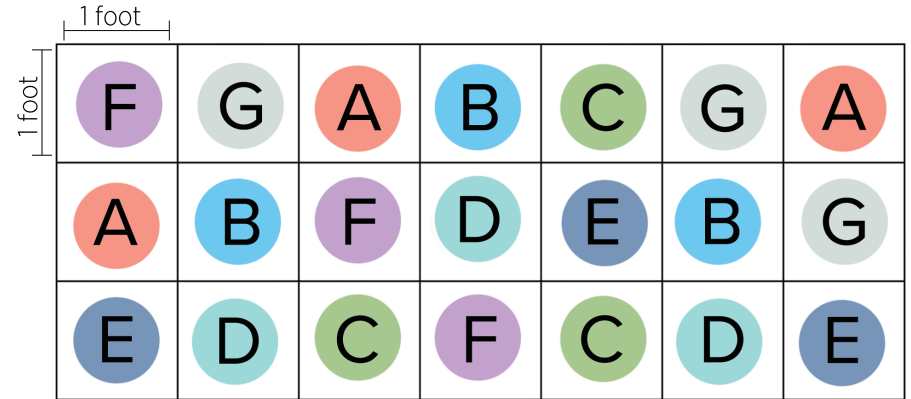

*good for containers/planters

+ suited to a range of growing conditions



A Mountain Mint**
Pycnanthemum muticum



E Butterfly Weed
Asclepias tuberosa



B Purple Coneflower+
Echinacea purpurea



F Prairie Dropseed
Sporobolus heterolepis

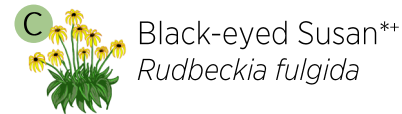

C Black-eyed Susan**
Rudbeckia fulgida



G Little Bluestem
Schizachyrium scoparium



D Aromatic Aster
Symphotrichum oblongifolium

Designed by Our Partners at:



 Audubon | MID-ATLANTIC

pa.audubon.org/blooms

Funded in part by the Donald B. and Dorothy L. Stabler Foundation.

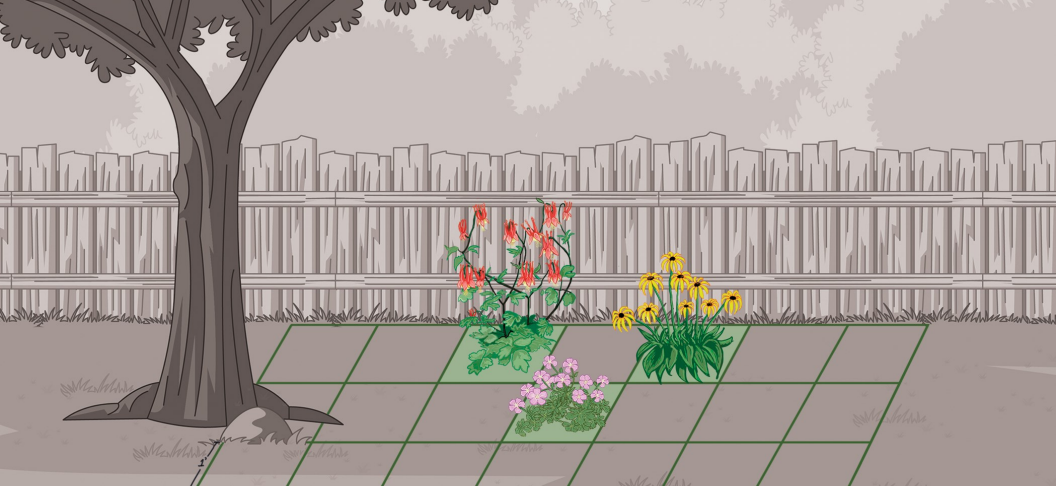

Start Small

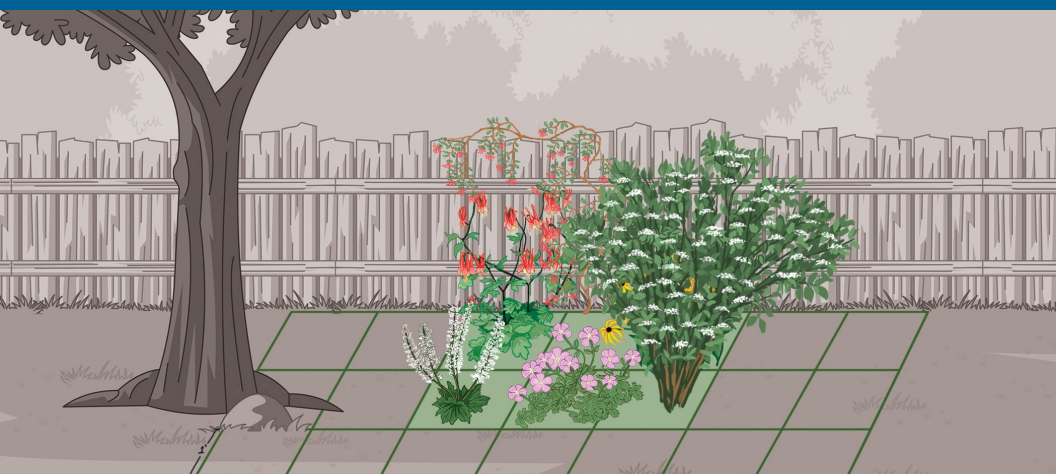

Add More Variety

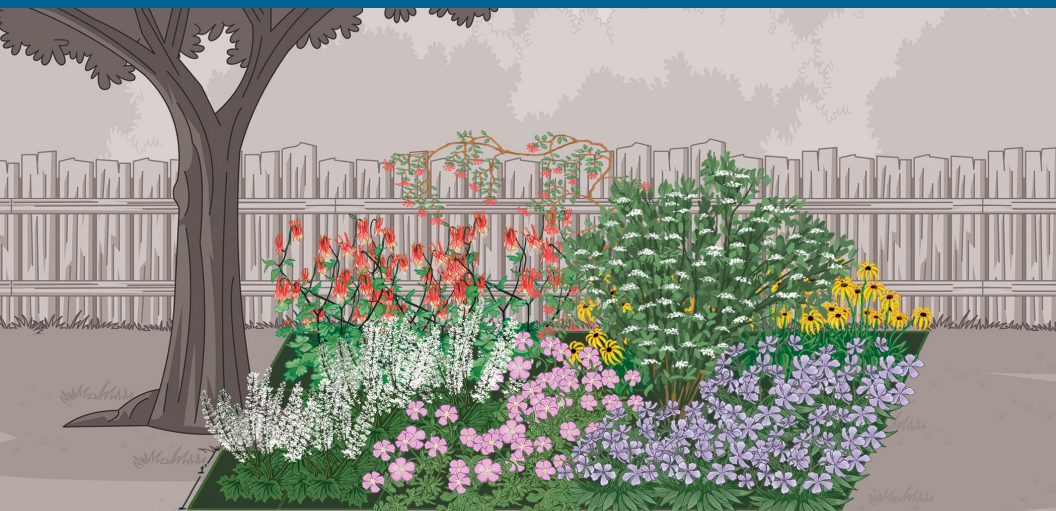

Expand & Enjoy!

PLANTING DIAGRAM

PART SUN / AVERAGE SOIL

1 foot	1 foot					
	A	A	A	E	C	C
		F	F	B	D	G
	F	F	B	B	G	G

*good for containers/planters

+ suited to a range of growing conditions

A



Eastern Red Columbine*
Aquilegia canadensis

E



Trumpet Honeysuckle*
Lonicera sempervirens

B



Wild Geranium
Geranium maculatum

F



Hairy Alumroot*
Heuchera villosa

C



Black-eyed Susan**
Rudbeckia fulgida

G



Woodland Phlox
Phlox divaricata

D



Arrowwood Viburnum*
Viburnum dentatum

Designed by Our Partners at:



Audubon | MID-ATLANTIC

pa.audubon.org/blooms

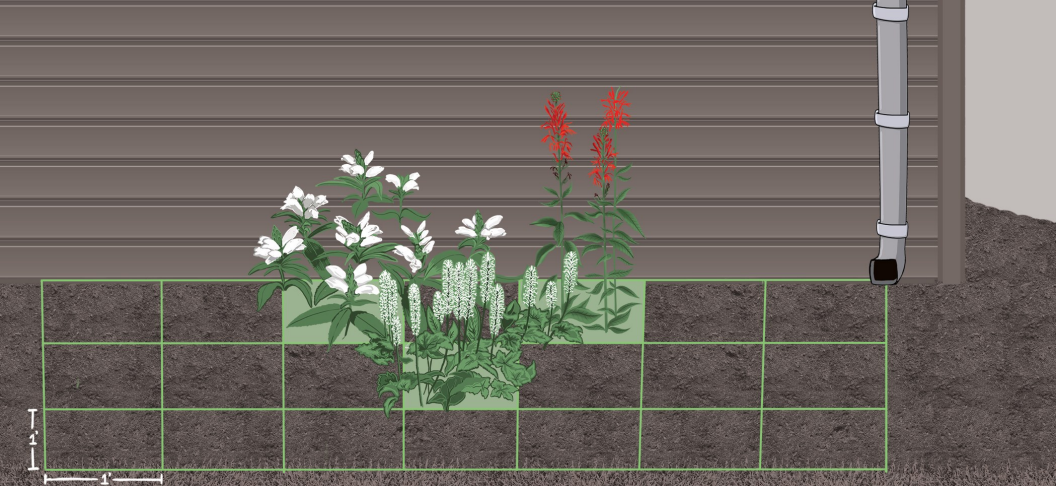

Start Small

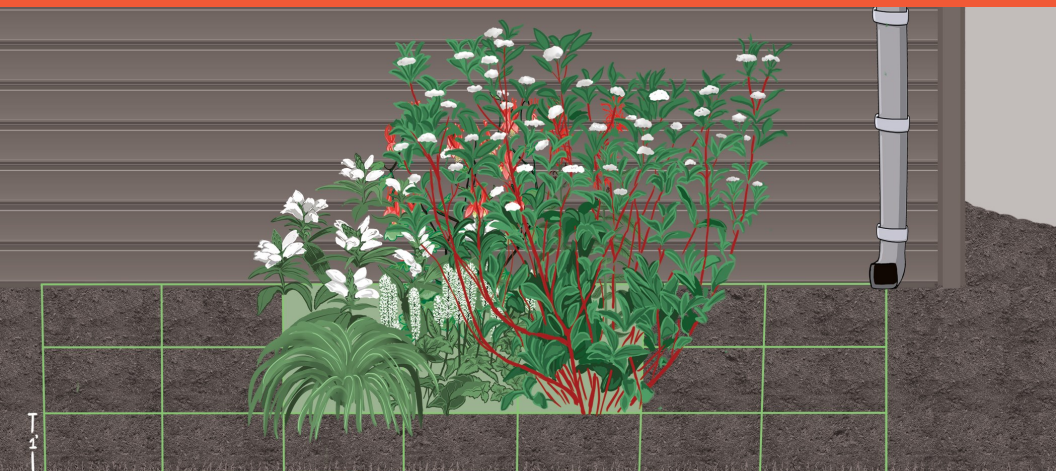

Add More Variety



Expand & Enjoy!

PLANTING DIAGRAM

SHADE / MOIST SOIL

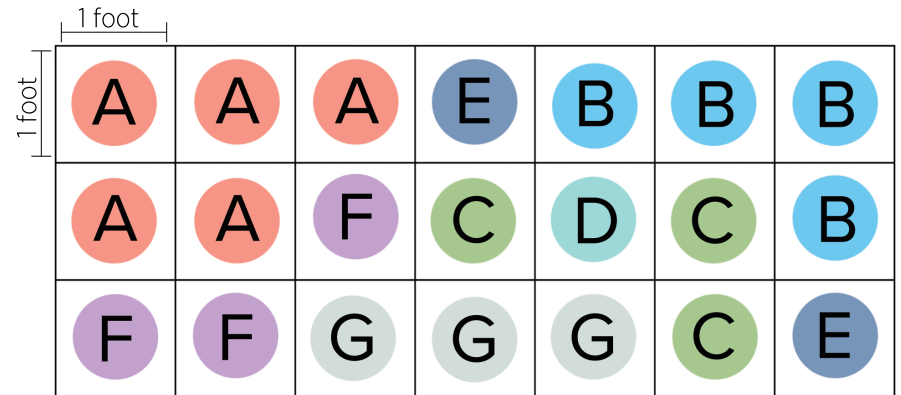

*good for containers/planters

+ suited to a range of growing conditions



Turtlehead
Chelone glabra



Eastern Red Columbine*
Aquilegia canadensis

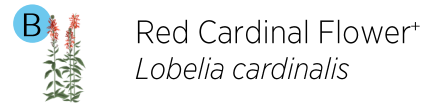

Red Cardinal Flower*
Lobelia cardinalis



Creeping Sedge
Carex laxiculmis



Foamflower*
Tiarella cordifolia

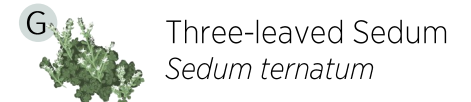

Three-leaved Sedum
Sedum ternatum

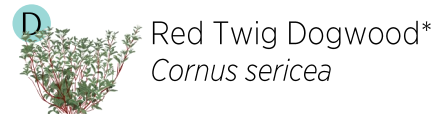

Red Twig Dogwood*
Cornus sericea

Designed by Our Partners at:



 **Audubon** | MID-ATLANTIC

pa.audubon.org/blooms